

DEEP FAITH • STRONG MINDS • BRIGHT FUTURES

A Legacy Worth Building

CLINTON CHRISTIAN SCHOOL
CAPITAL CAMPAIGN

EXTERIOR 100'-9" X 12'-8" *"Unless the Lord builds the house, the builders labor in vain."*
Psalm 127:1



	COPY OF SIDING-6 METAL
	6" CONCRETE STEM WALL_2
	-NEW BLOCK WALL
	INTERIOR-4_2
	SIDING-6
	INTERIOR RAILING
	ROOM DIVIDER
	INT. SYS

CLINTON CHRISTIAN SCHOOL



THE FOUNDATION

Since 1950, Clinton Christian School has stood as a testimony to God's faithfulness, preparing students for life and service in Christ.

As the first Christian school in Goshen, CCS and its leadership have led the way in Christ-centered education, remaining committed to providing a place where students grow academically, spiritually, and relationally.



A commitment to expanding opportunities for CCS students, their families, and the community has guided every phase of growth and expansion.

As more families discover the difference a CCS education can make, we remain committed to fiscally responsible growth that meets the evolving needs of the 21st-century learner.



LEGACY

OUR MISSION

Clinton Christian School exists to provide a Christ-centered education focused on academic excellence, moral integrity, and spiritual depth — preparing students to follow Christ in life.

CCS Students Will:

Experience worship, community, and spiritual growth.

Prepare for college and career with excellence.

Engage in hands-on exploration and learning.

Enjoy a safe, welcoming campus community.

Express God-given creativity in the arts.

Compete with character through Christ-centered athletics.

WE ACHIEVE THIS BY REMAINING:

DISTINCTLY CHRISTIAN

Integrating faith into every subject and providing opportunities for students to further explore and grow their personal relationship with Jesus.

DECIDEDLY EXCELLENT

Committed to academics that challenge and equip our students to be the leaders of today and tomorrow.

DEEPLY CONNECTED

Creating a community where every student is known and valued.

THE CHALLENGE

Our Mission Is Strong.
Our Space Is Stretched.



At Clinton Christian our mission has never been clearer: to cultivate students who thrive academically, spiritually, and socially.

Families continue to seek the Christ-centered education our school provides, and enrollment continues to grow.

But with that growth comes a challenge.

Our current facilities, are reaching their limits. Classrooms are full, shared spaces are stretched, and opportunities for expanded programming are constrained by the space available.

Our campus reflects the heart of our mission, but it is beginning to limit the opportunities we can provide for our students.

Will you help us increase our impact and advance the mission?

WALL SCHEDULE	
2D SYMBOL	WALL TYPE
	6" CONCRETE STEM WALL_2
	8" CMU (BLOCK) STEM WALL
	COPY OF SIDING-6 METAL
	6" CONCRETE STEM WALL_2
	-NEW BLOCK WALL
	INTERIOR-4_2
	SIDING-6
	INTERIOR RAILING
	ROOM DIVIDER

- CONTINUING THE LEGACY -



Expand Classroom Spaces

To ensure smaller class ratios, meet growing enrollment needs, and provide more specialized learning labs.



Construct a New Kitchen

To serve students, expand class offerings, and host community events.



Add a Dedicated Science Lab

Creating a space for STEM exploration, experimentation, and discovery.



Build a Multi-Purpose Space

A flexible space for chapel, cafeteria, and athletic practices.



Enhance Bathroom Facilities

In-classroom facilities for K-1 increases safety, while providing additional facilities to support our growing school.



Expand and Pave the Parking Lot

Improving safety, accessibility, and hospitality for families and visitors.

Together, we are building the kind of environment students need to thrive — physically, socially, and spiritually.



THE VISION

This campaign is not about buildings —
it's about transformation.

Campaign Goals

1 Phase 1: \$2.5 Million

- New kitchen, science room, art room, Spanish room
- New JH/HS bathrooms
- Remodeled lower elementary bathrooms
- Four standard classrooms
- Porch overhang for pick-up area
- New mechanical room & utilities infrastructure

2 Exterior Enhancements: \$400,000

- Paved parking lot and wrap-around drive
- Parking lot lights

3 Phase 3: \$2.2 Million

- New practice gym
- Stage & multi-purpose space
- Nine JH/HS classrooms
- LSS and HS staff offices
- Porch overhang for pick-up area
- Athletic storage facilities

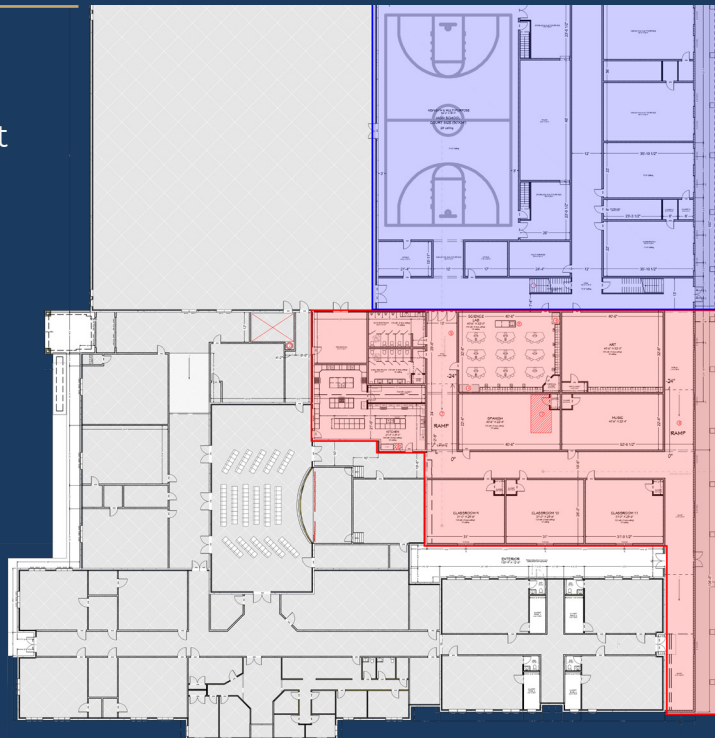

Phase 2

Phase 1

Campaign & Construction Timeline



Capital Campaign
Spring 2026-Winter 2027

Final Drawings Completed
Fall 2026

Construction
Spring 2027

Occupancy
Fall 2027 or Spring 2028

JOIN US

This is a Legacy Worth Building

Frequent Gift Types

- Multi Year Pledges
- Stocks, Mutual Funds, and Securities
- In Memoriam
- One time lump sum
- Real estate gifts
- Life insurance
- Retirement plans
- Matching gifts

Small Sacrifice → Eternal Impact

Small, intentional choices today can make a lasting difference for generations to come at CCS.

Everyday Choice	1 Year of Giving	3 Years of Giving
 Skip one coffee trip per week \$6/week	\$312 per year 52 weeks x \$6	\$936 over 3 years \$312 x 3 years
 Skip one takeout meal per week \$20/week	\$1,040 per year 52 weeks x \$20	\$3,120 over 3 years \$1,040 x 3 years
 Cut one extra monthly expense \$100/week	\$1,200 per year \$100 x 12 months	\$3,600 over 3 years \$1,200 x 3 years
 Your Impact in Action		
\$2,552 per year \$7,656 over 3 years		
WILL YOU JOIN OUR LEGACY CAMPAIGN?		



Your donation helps fulfill God's calling for CCS and positions our school to grow in faith and excellence for generations to come.



Scan the QR code to learn more about ways to give & follow the progress of the A Legacy Worth Building Campaign.

Structure

2D SYMBOL	WALL SCHEDULE
[Symbol]	WALL TYPE
[Symbol]	8" CONCRETE STEM WALL
[Symbol]	8" CMU (BLOCK) STEM WALL
[Symbol]	COPY OF SIDING-6 METAL

A LASTING IMPACT

RAMP 6

For every student who will walk these halls — from kindergarten to graduation and beyond.



Deep Faith. Strong Minds. Bright Futures.

	8" CONCRETE STEM WALL_2
	8" CMU (BLOCK) STEM WALL



	SIDING-6
	INTERIOR RAILING